

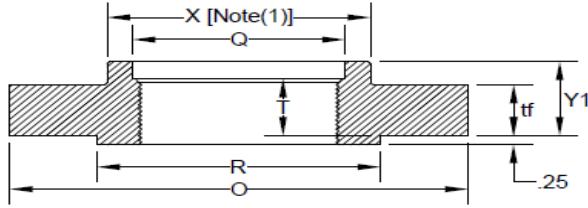

# CLASS 2500 FLANGE

## ASME B16.5-2017



Threaded (NPS 1/2 to 2 1/2 Only)

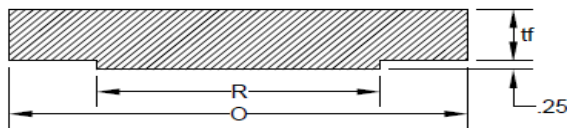

Blind

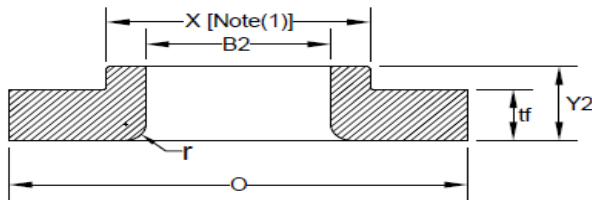

Lapped

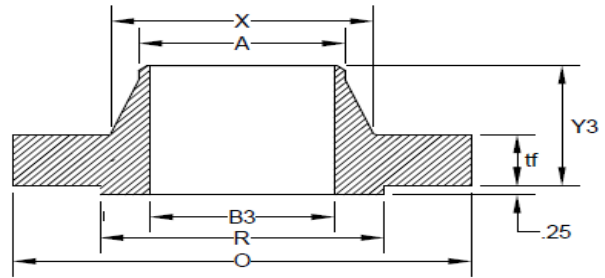

Welding Neck

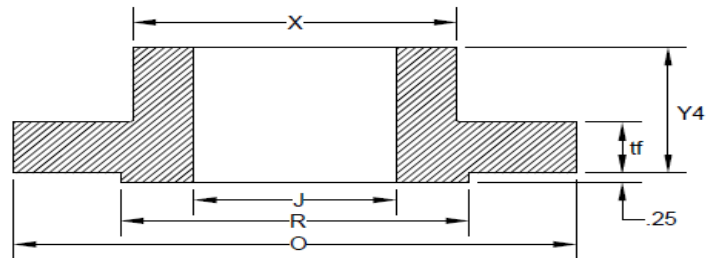

Long Welding Neck

Nominal Pipe Size/ Bore for LWN J	Outside Diameter O	Min. Thickness tf	Diameter of Raised Face R	Diameter of Hub X	Hub Diameter Beginning of Chamfer of Welding Neck A	Length Through Hub				Bore			Corner Bore Radius of Lapped Flange and Pipe r	Minimum Counter-bore Threaded Flange Q	Bolt Circle Dia	Number of Holes	Diameter of Holes
						Threaded Y1	Lapped Y2	Welding Neck Y3	Long Welding Neck Y4	Minimum Thread Length Threaded T	Minimum Lapped B2	Welding Neck B3					
1/2	5.25	1.19	1.38	1.69	0.84	1.56	1.56	2.88	9.00	1.12	0.90	Note-3	0.12	0.93	3.50	4	0.88
3/4	5.50	1.25	1.69	2.00	1.05	1.69	1.69	3.12	9.00	1.25	1.11	Note-3	0.12	1.14	3.75	4	0.88
1	6.25	1.38	2.00	2.25	1.32	1.88	1.88	3.50	9.00	1.38	1.38	Note-3	0.12	1.41	4.25	4	1.00
1 1/4	7.25	1.50	2.50	2.88	1.66	2.06	2.06	3.75	9.00	1.50	1.72	Note-3	0.19	1.75	5.12	4	1.13
1 1/2	8.00	1.75	2.88	3.12	1.90	2.38	2.38	4.38	9.00	1.75	1.97	Note-3	0.25	1.99	5.75	4	1.25
2	9.25	2.00	3.62	3.75	2.38	2.75	2.75	5.00	9.00	2.00	2.46	Note-3	0.31	2.50	6.75	8	1.13
2 1/2	10.50	2.25	4.12	4.50	2.88	3.12	3.12	5.62	9.00	2.25	2.97	Note-3	0.31	3.00	7.75	8	1.25
3	12.00	2.62	5.00	5.25	3.50	-	3.62	6.62	9.00	-	3.60	Note-3	0.38	-	9.00	8	1.38
4	14.00	3.00	6.19	6.50	4.50	-	4.25	7.50	Note-3	-	4.60	Note-3	0.44	-	10.75	8	1.63
5	16.50	3.62	7.31	8.00	5.56	-	5.12	9.00	12.00	-	5.69	Note-3	0.44	-	12.75	8	1.88
6	19.00	4.25	8.50	9.25	6.63	-	6.00	10.75	12.00	-	6.75	Note-3	0.50	-	14.50	8	2.13
8	21.75	5.00	10.63	12.00	8.63	-	7.00	12.50	12.00	-	8.75	Note-3	0.50	-	17.25	12	2.13
10	26.50	6.50	12.75	14.75	10.75	-	9.00	16.50	12.00	-	10.92	Note-3	0.50	-	21.25	12	2.63
12	30.00	7.25	15.00	17.38	12.75	-	10.00	18.25	12.00	-	12.92	Note-3	0.50	-	24.38	12	2.88

Notes:

- (1) This dimension is for the large end of the hub, which may be straight or tapered. Taper shall not exceed 7 deg on threaded, slip-on, socket-welding, and lapped flanges.
- (2) When these flanges are required with flat face, the flat face may be either the full  $t_f$  dimension thickness plus 0.06 in. or the  $t_f$  dimension thickness without the raised face height.
- (3) To be specified by the Customer; Y4 - the length can be 9" (B16.5) or 12" (industry), shall be specified by the customer.